

PRODUCT DATA FOR STANDARD BI-DIRECTIONAL MAGNETIC PIG

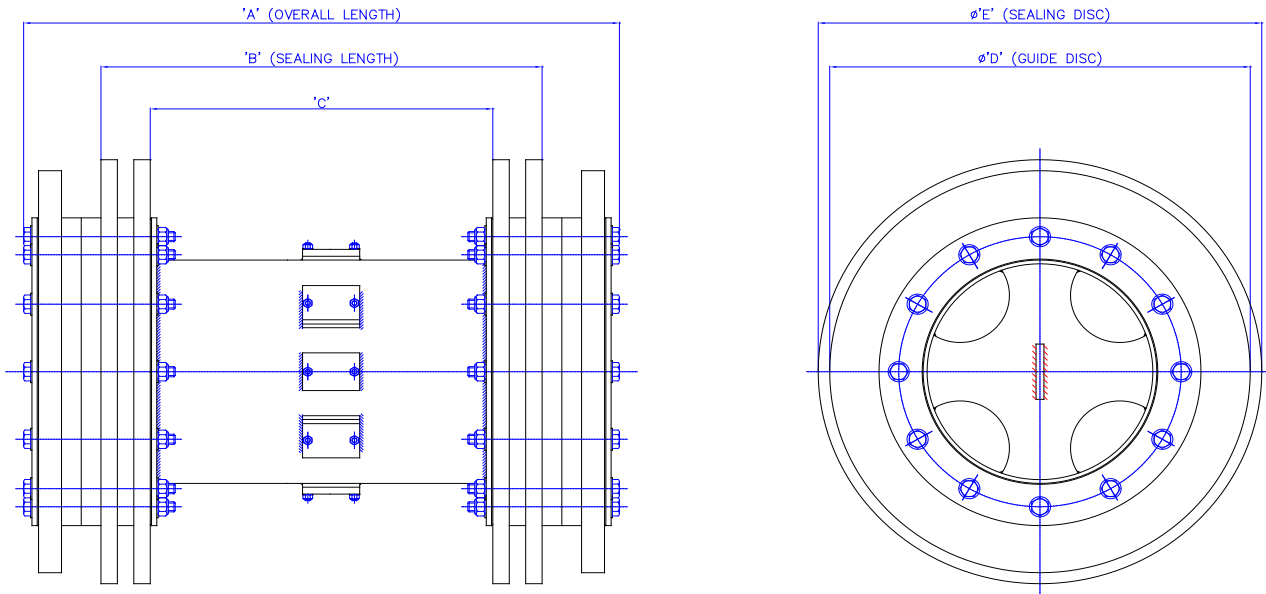

PIG N.S.	'A' (mm)	'B' (mm)	'C' (mm)	'D' = SIZE BELOW PIPE I.Dia	'E' = SIZE ABOVE PIPE I.Dia	MINIMUM BEND RADIUS	WEIGHT (Kg)	PART No.
10"	460	210	120	1 to 3mm	15 to 25mm	3D	24	PBM.10.1001
12"	460	315	220	1 to 3mm	15 to 25mm	3D	28	PBM.12.1001
14"	520	370	270	2 to 4mm	15 to 25mm	3D	41	PBM.14.1001
16"	590	420	310	2 to 4mm	15 to 25mm	3D	47	PBM.16.1001
18"	620	470	370	2 to 4mm	20 to 30mm	3D	70	PBM.18.1001
20"	690	520	410	2 to 4mm	20 to 30mm	1.5D	82	PBM.20.1001
22"	750	570	440	2 to 4mm	20 to 30mm	1.5D	117	PBM.22.1001
24"	820	620	480	2 to 4mm	20 to 30mm	1.5D	130	PBM.24.1001
26"	880	670	530	3 to 6mm	25 to 40mm	1.5D	171	PBM.26.1001
28"	950	720	570	3 to 6mm	25 to 40mm	1.5D	180	PBM.28.1001
30"	1020	770	600	3 to 6mm	25 to 40mm	1.5D	262	PBM.30.1001
32"	1075	825	655	3 to 6mm	30 to 50mm	1.5D	280	PBM.32.1001
34"	1130	875	705	3 to 6mm	30 to 50mm	1.5D	320	PBM.34.1001
36"	1175	925	760	3 to 6mm	30 to 50mm	1.5D	342	PBM.36.1001
38"	1235	975	800	3 to 6mm	30 to 50mm	1.5D	408	PBM.38.1001
40"	1290	1030	855	4 to 8mm	35 to 55mm	1.5D	435	PBM.40.1001
42"	1350	1080	880	4 to 8mm	35 to 55mm	1.5D	527	PBM.42.1001
48"	1550	1230	1015	4 to 8mm	35 to 55mm	1.5D	724	PBM.48.1001
56"	1805	1435	1185	6 to 12mm	40 to 60mm	1.5D	976	PBM.56.1001
60"	1750	1535	1325	6 to 12mm	40 to 60mm	1.5D	1102	PBM.60.1001

General Information

All details shown above are for information only and are subject to changes. Fully detailed general arrangement drawings are available on request from our technical sales department.